

# 模型製作

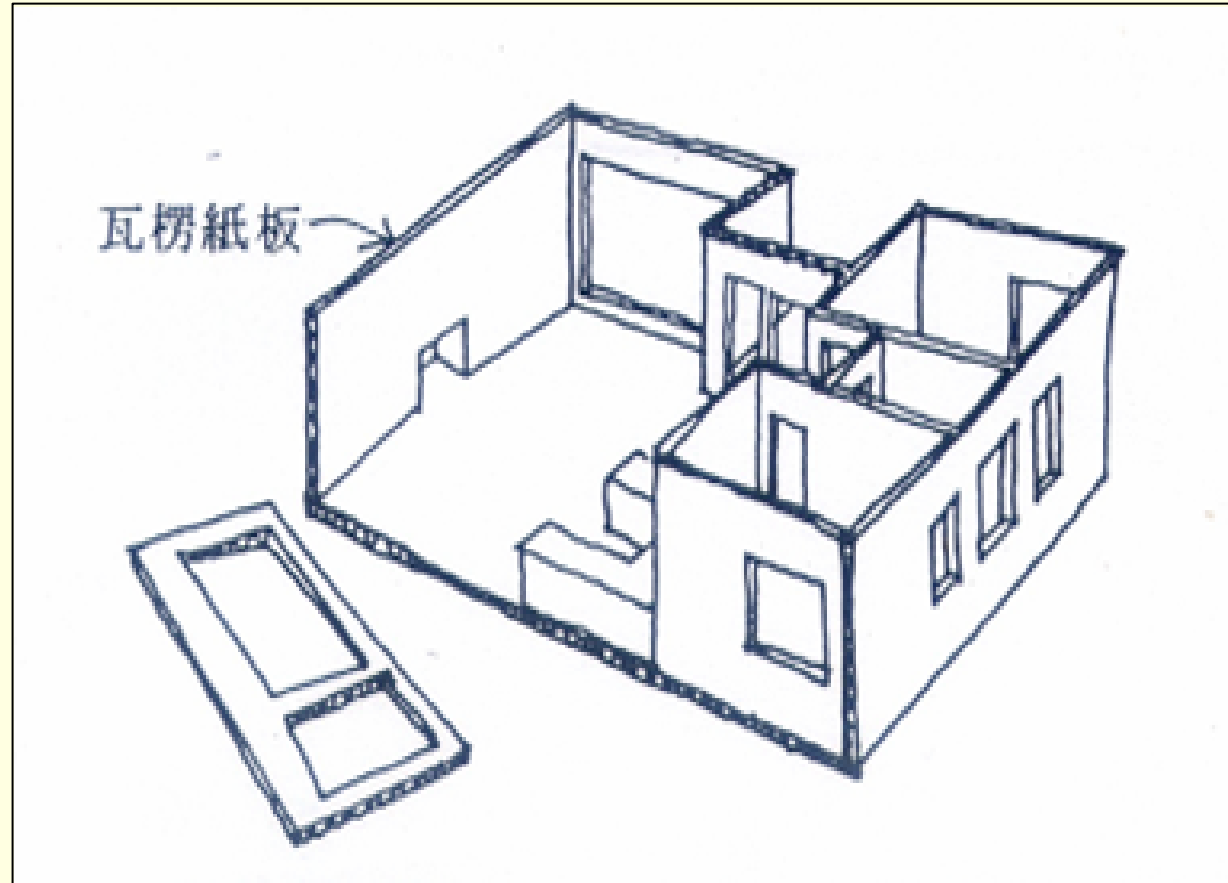

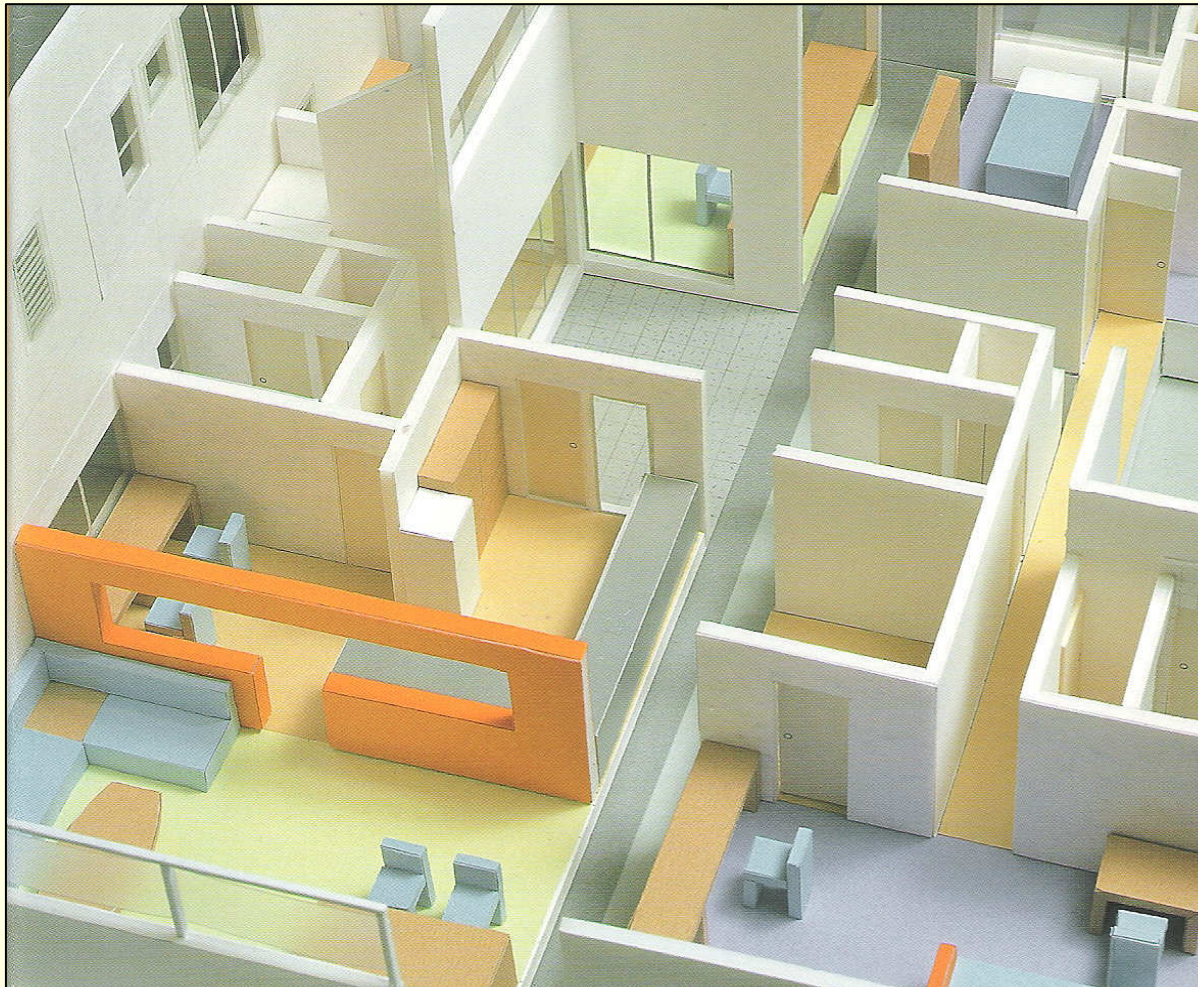

# 成品要求

- 1：100縮尺
- 建築外觀要完整呈現門窗等建築細部構造
- 屋頂可掀開，頂層要呈現內部隔間
- 細部構造如：電梯、門窗可用畫線處理或切割成開口
- 基底面要標示座向

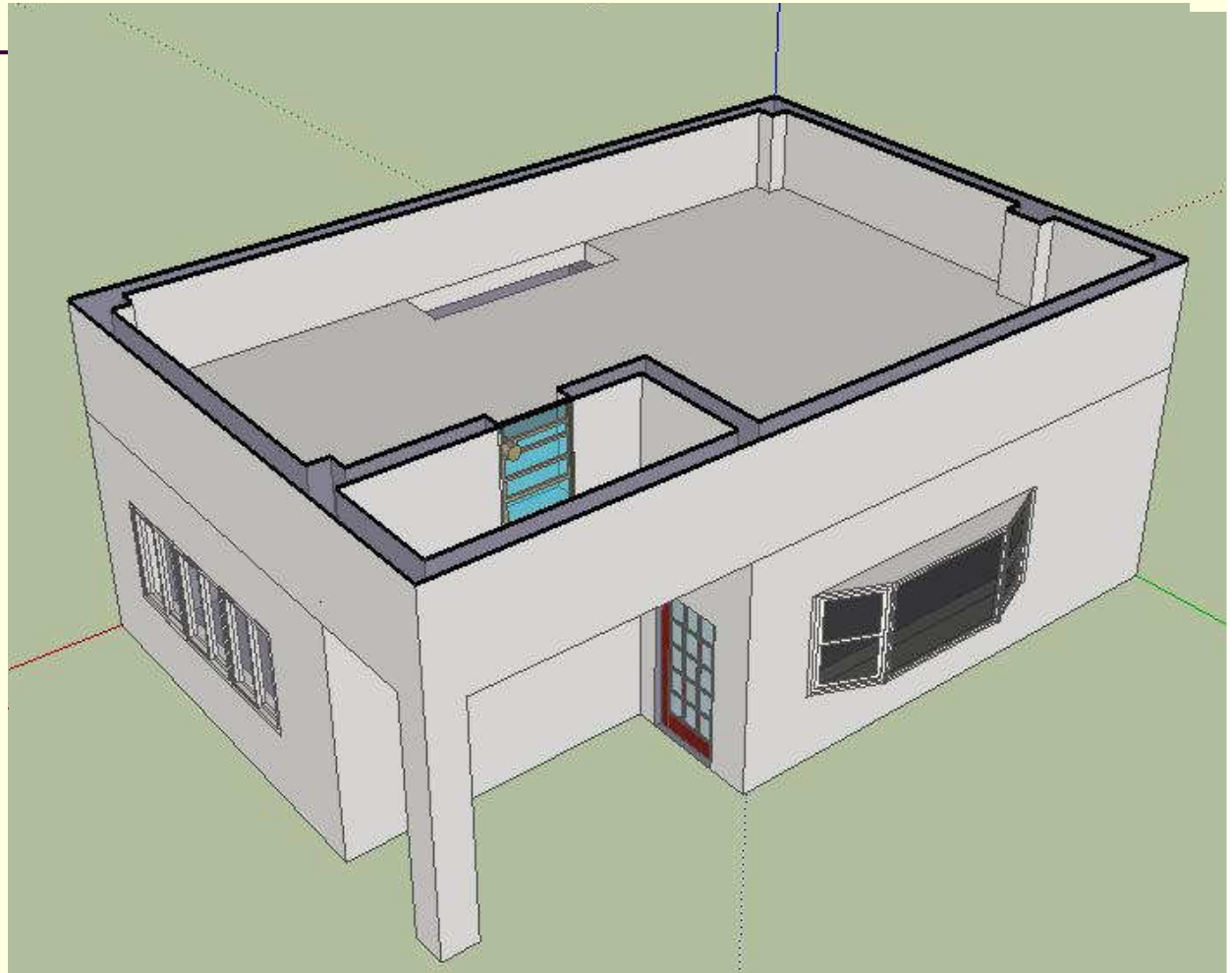

# 成品範例



# 成品範例

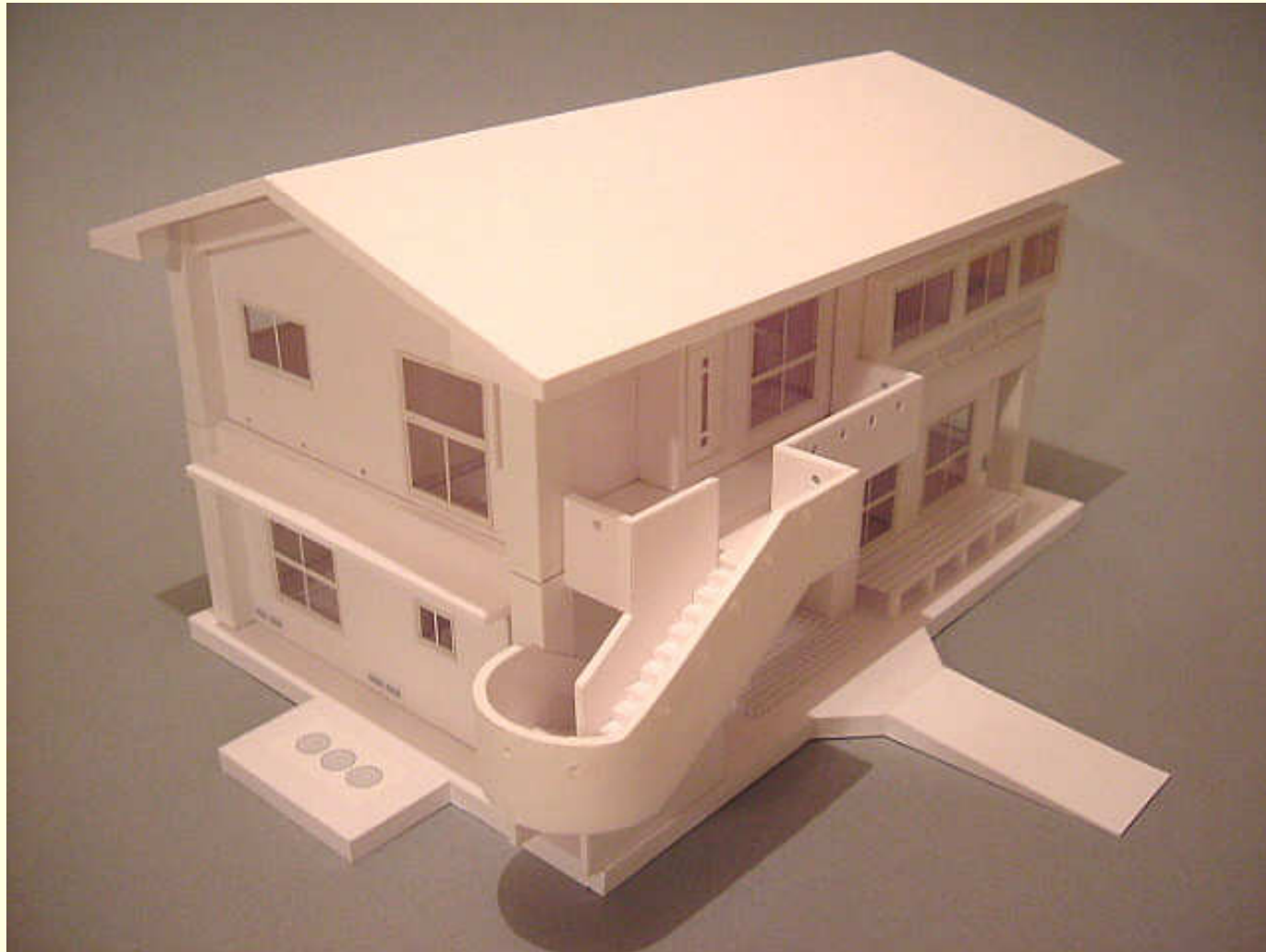

# 模型製作流程

---



# 模型製作流程

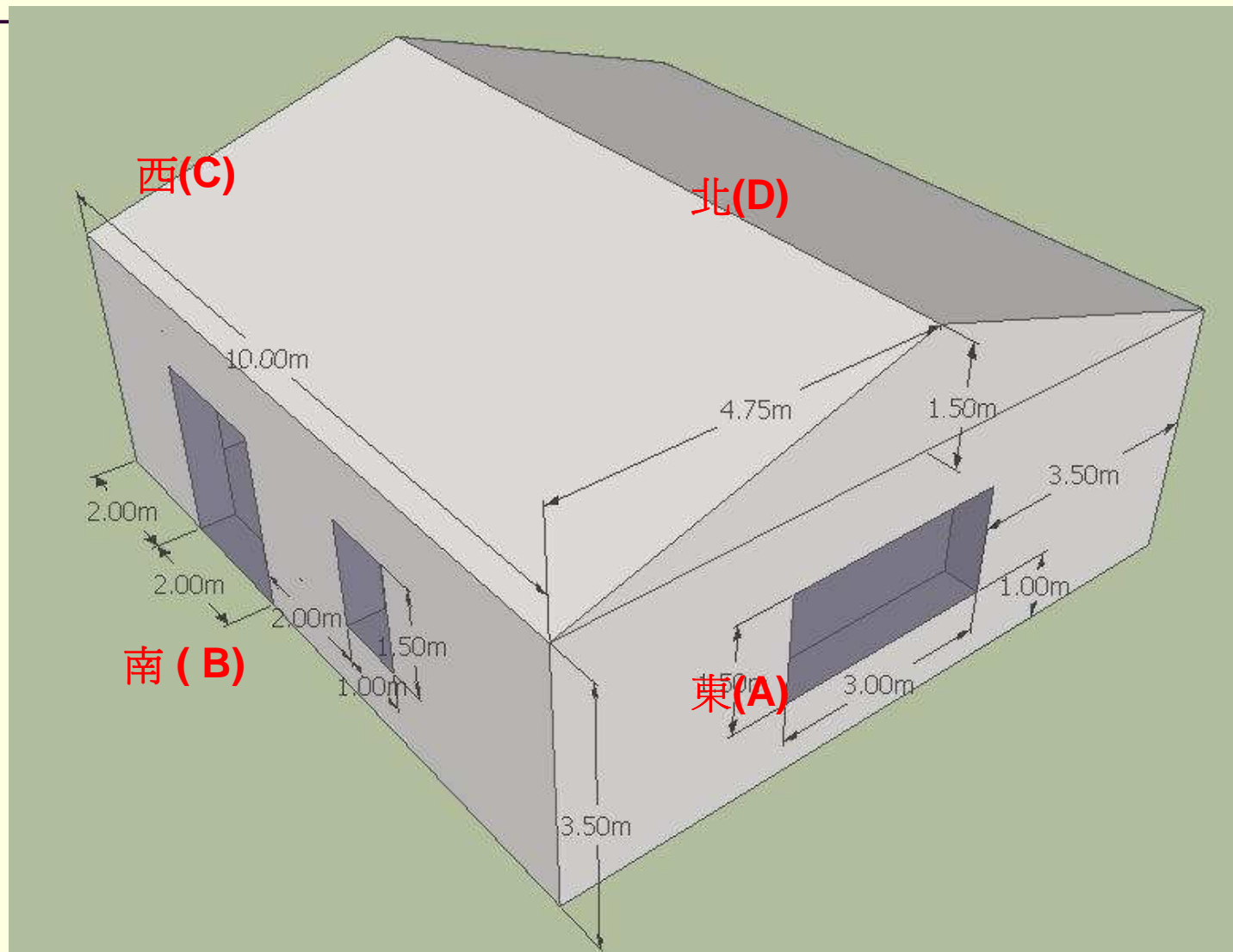



# 模型製作-放樣流程(平面配置)

- 在材料上畫線、標註尺度、編號

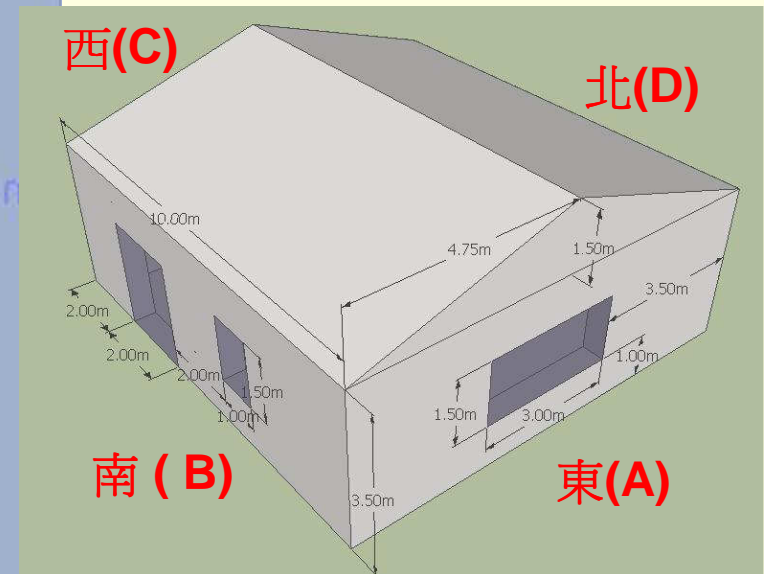
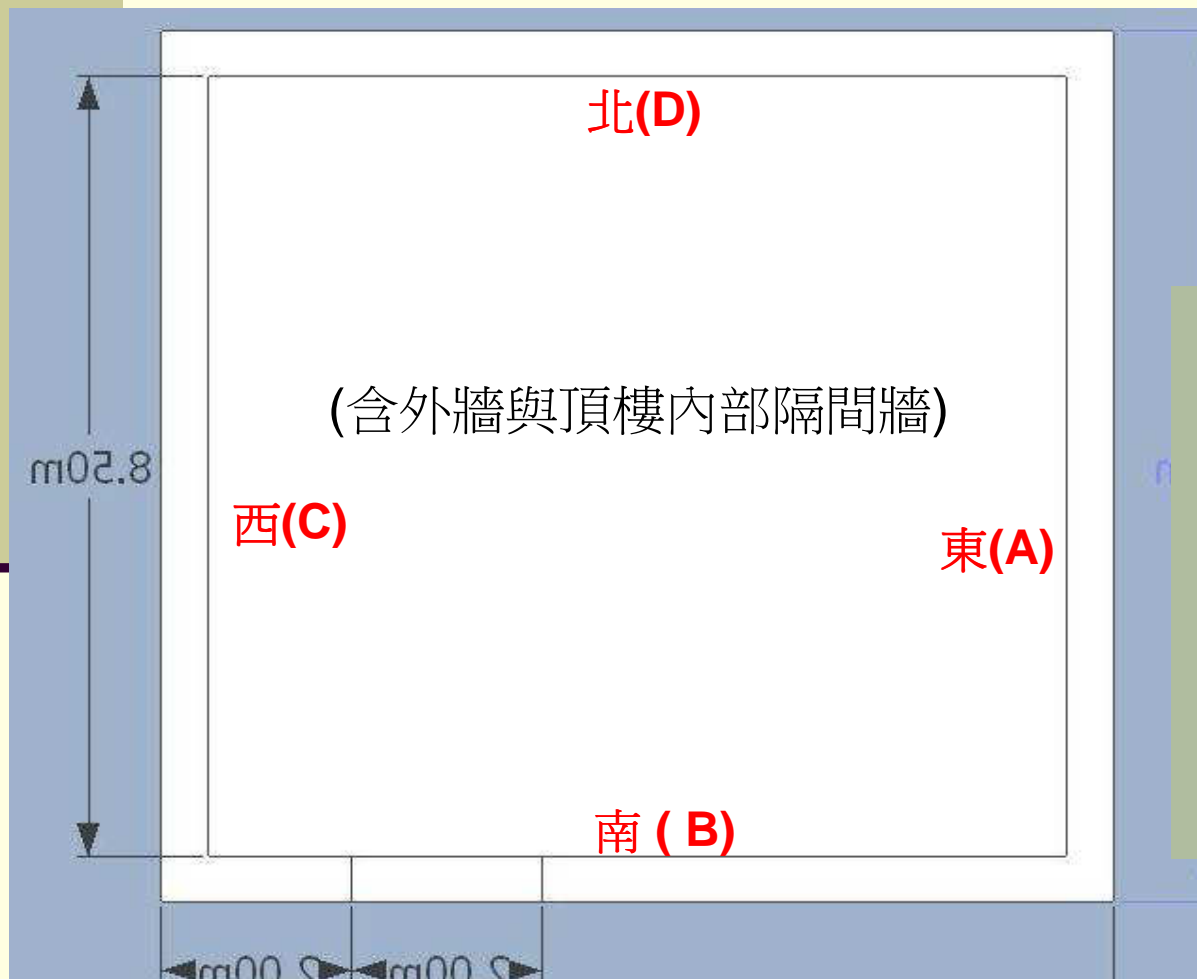

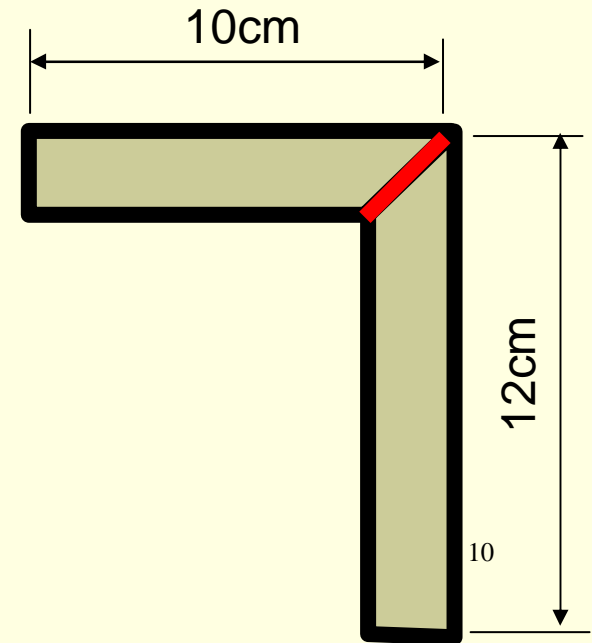
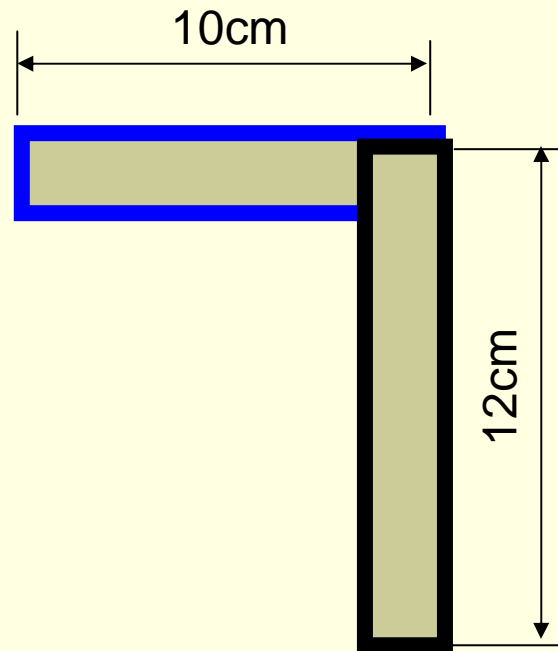
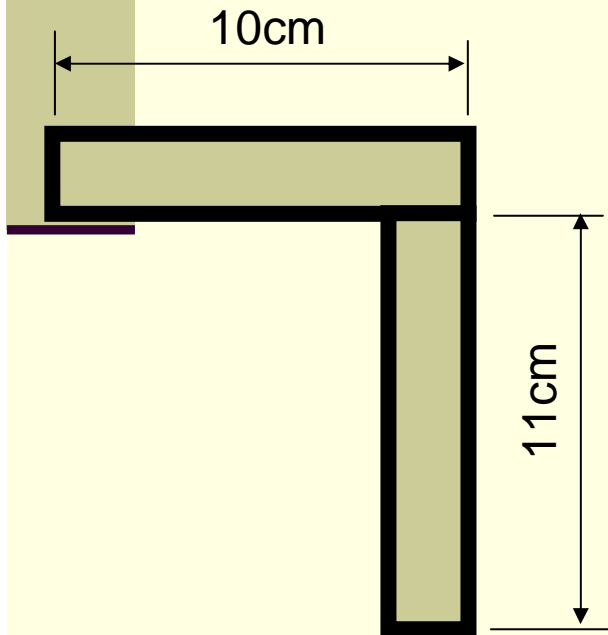
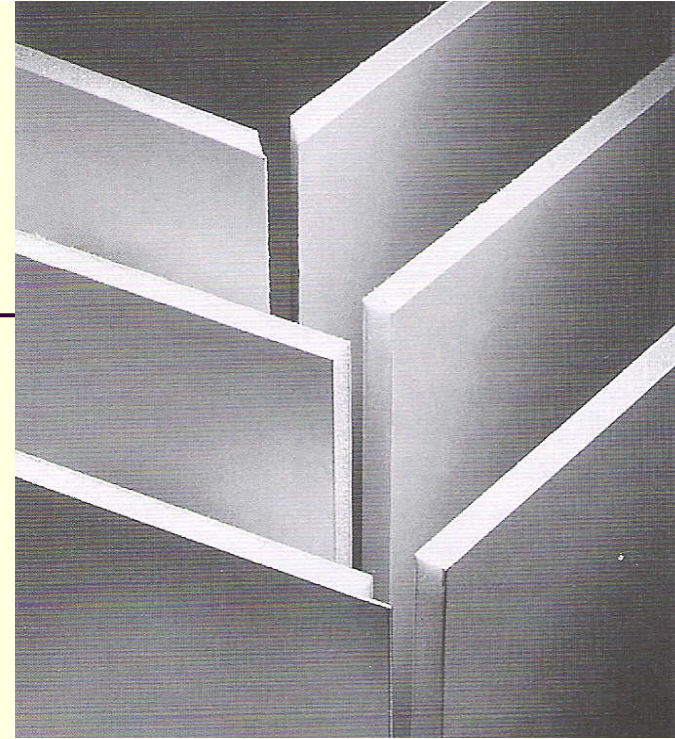
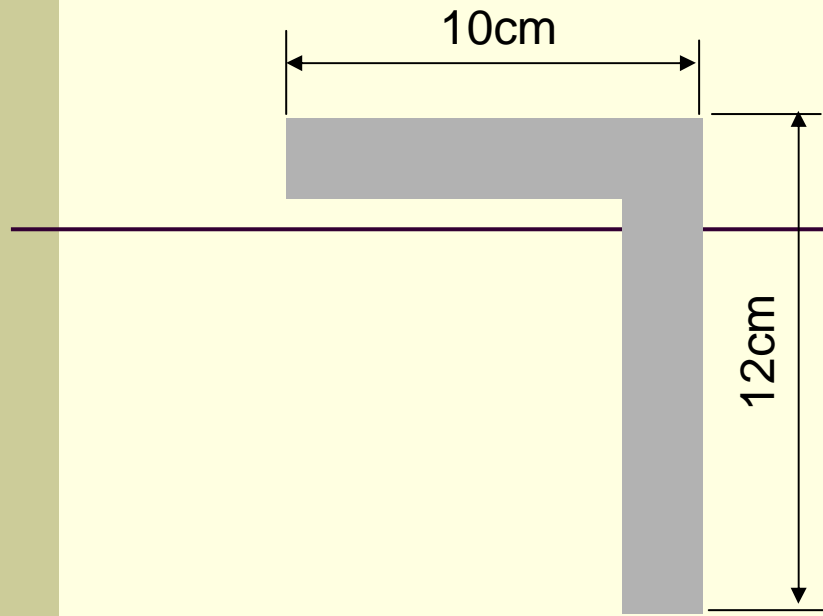

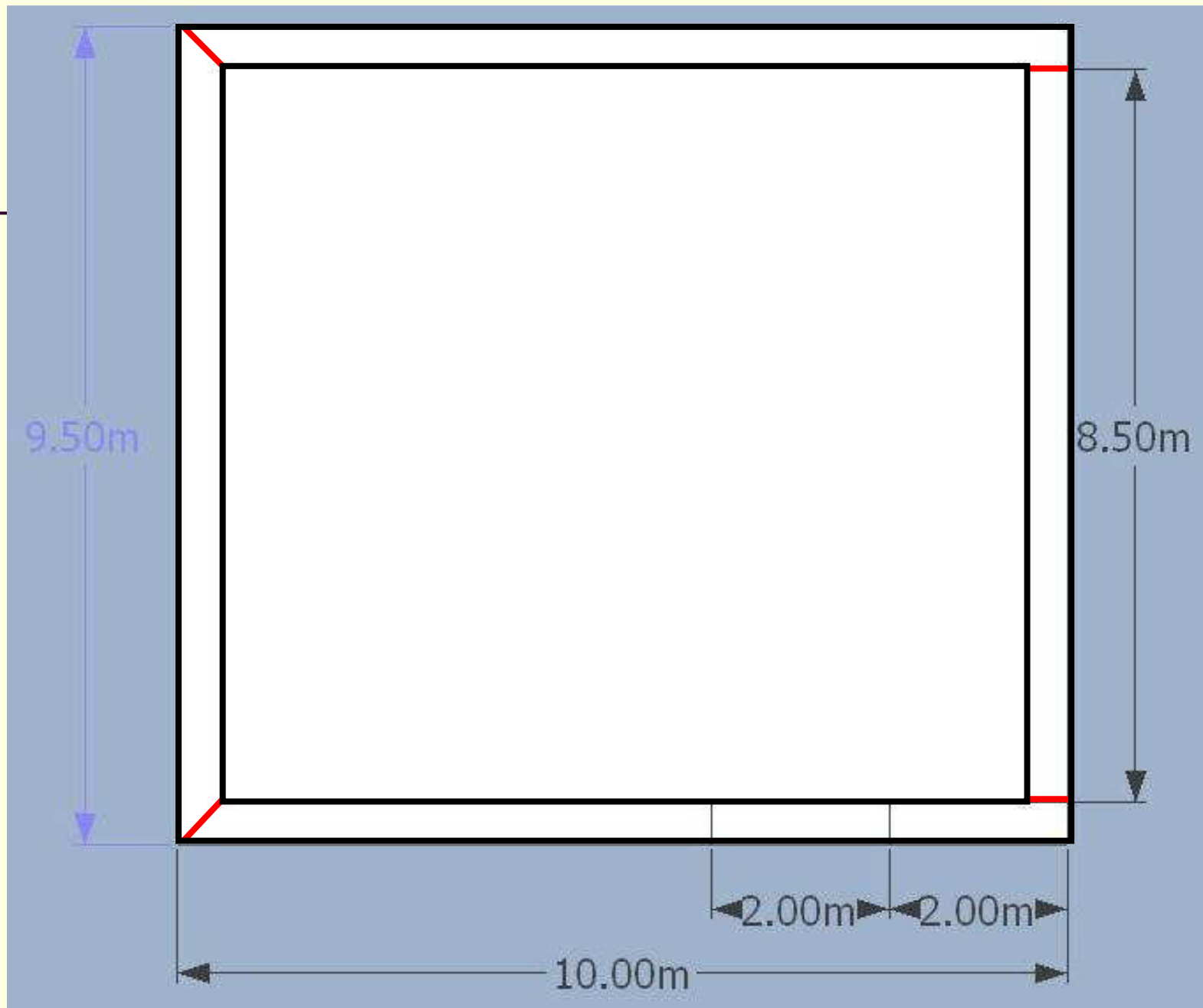

# 南-前立面

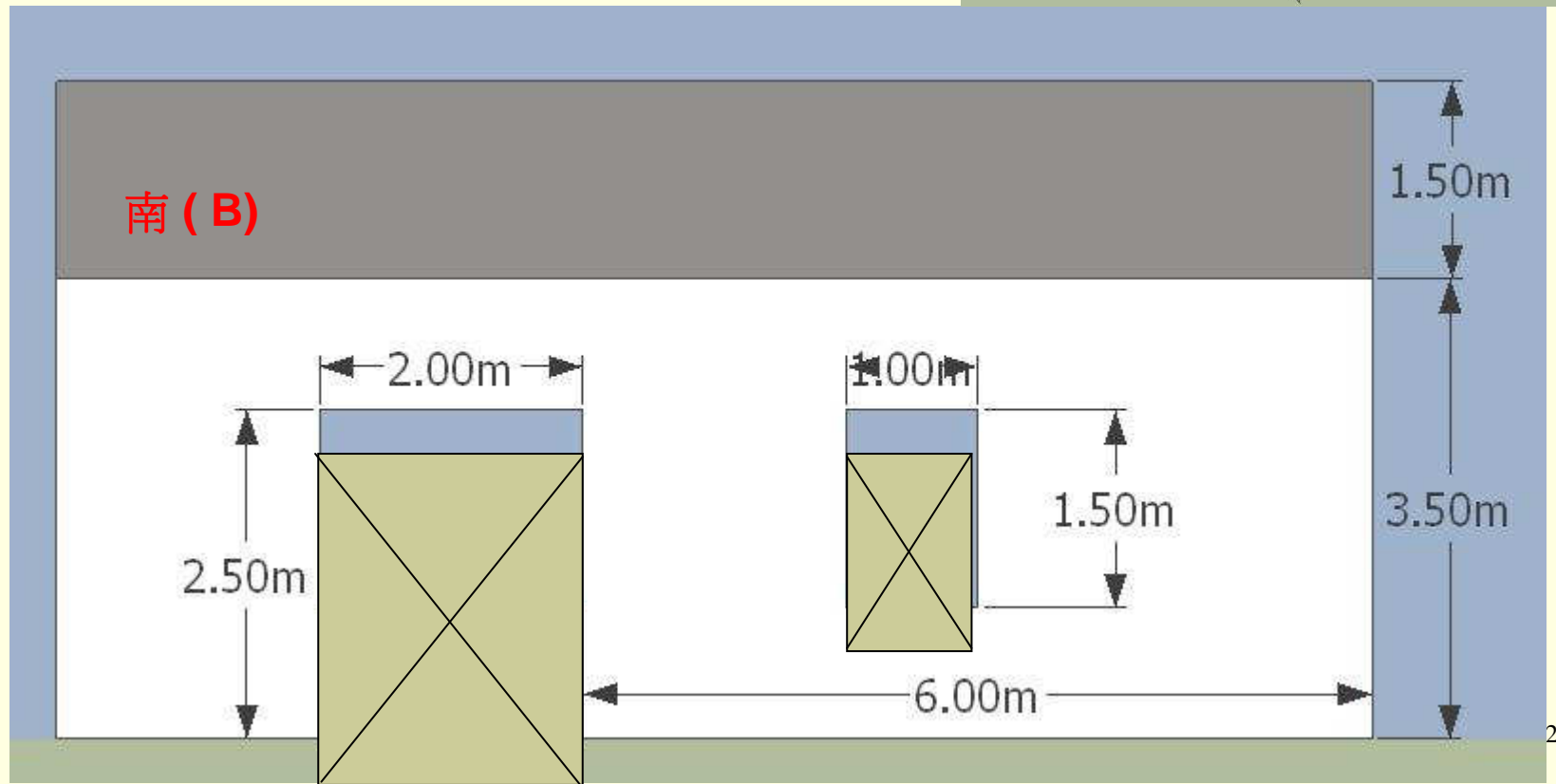
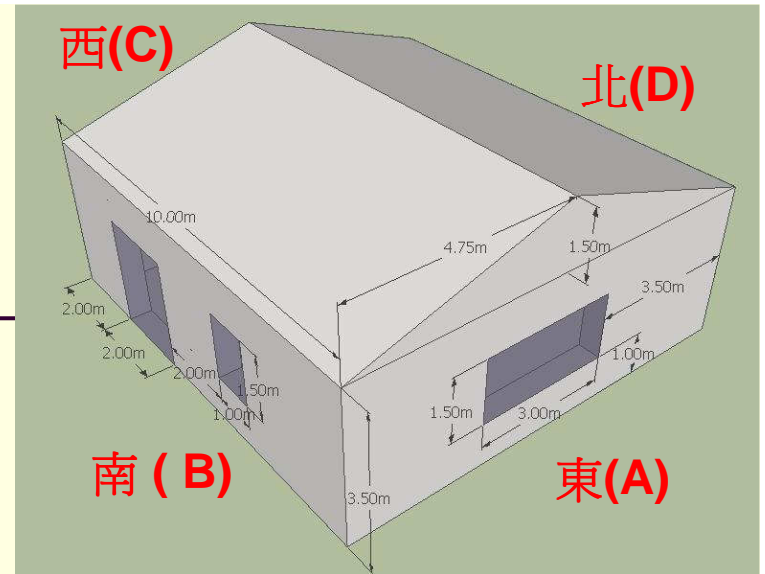

# 東-右立面

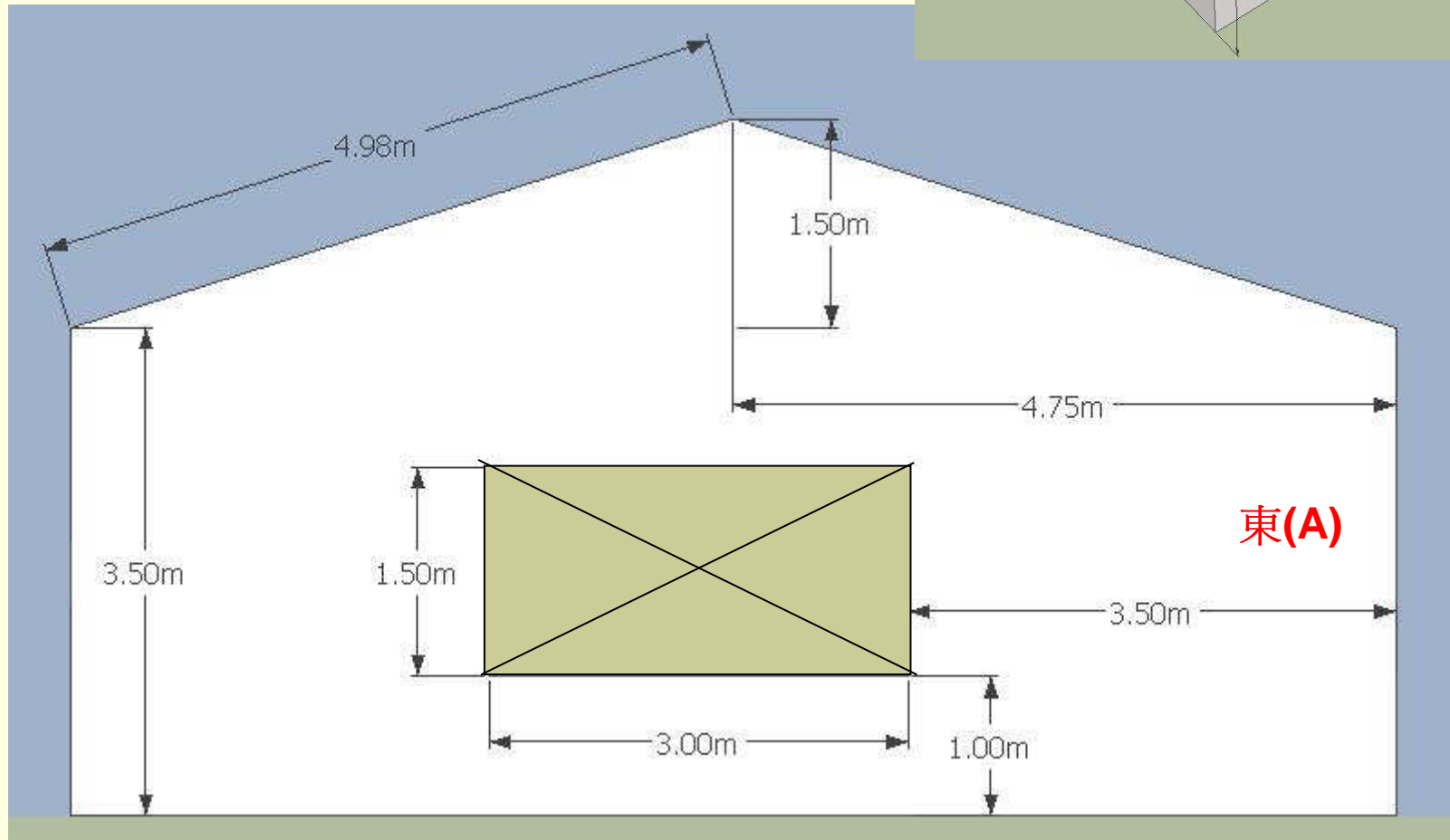
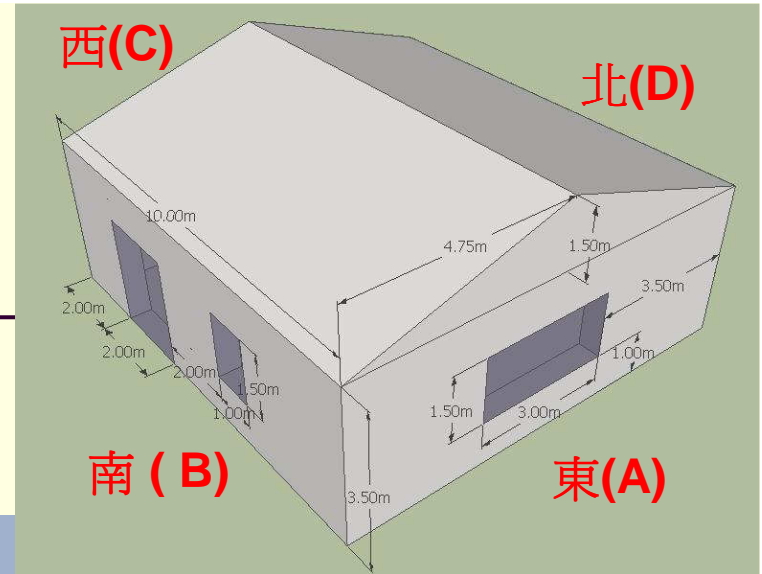

# 西-左立面

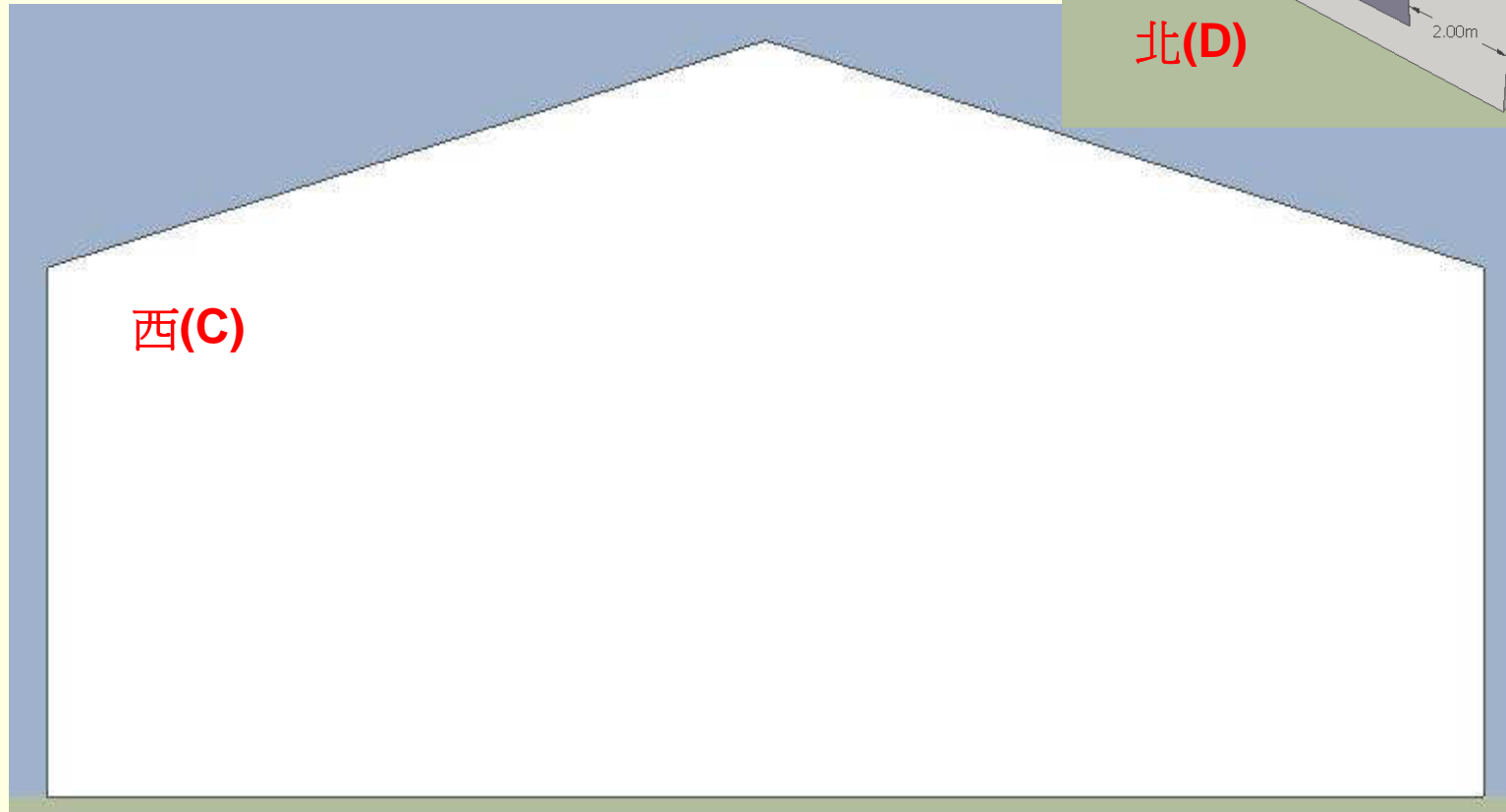
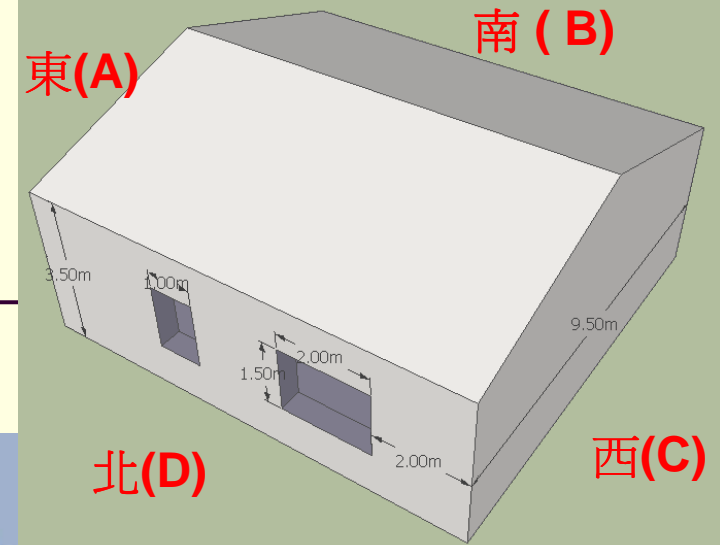

# 北-後立面

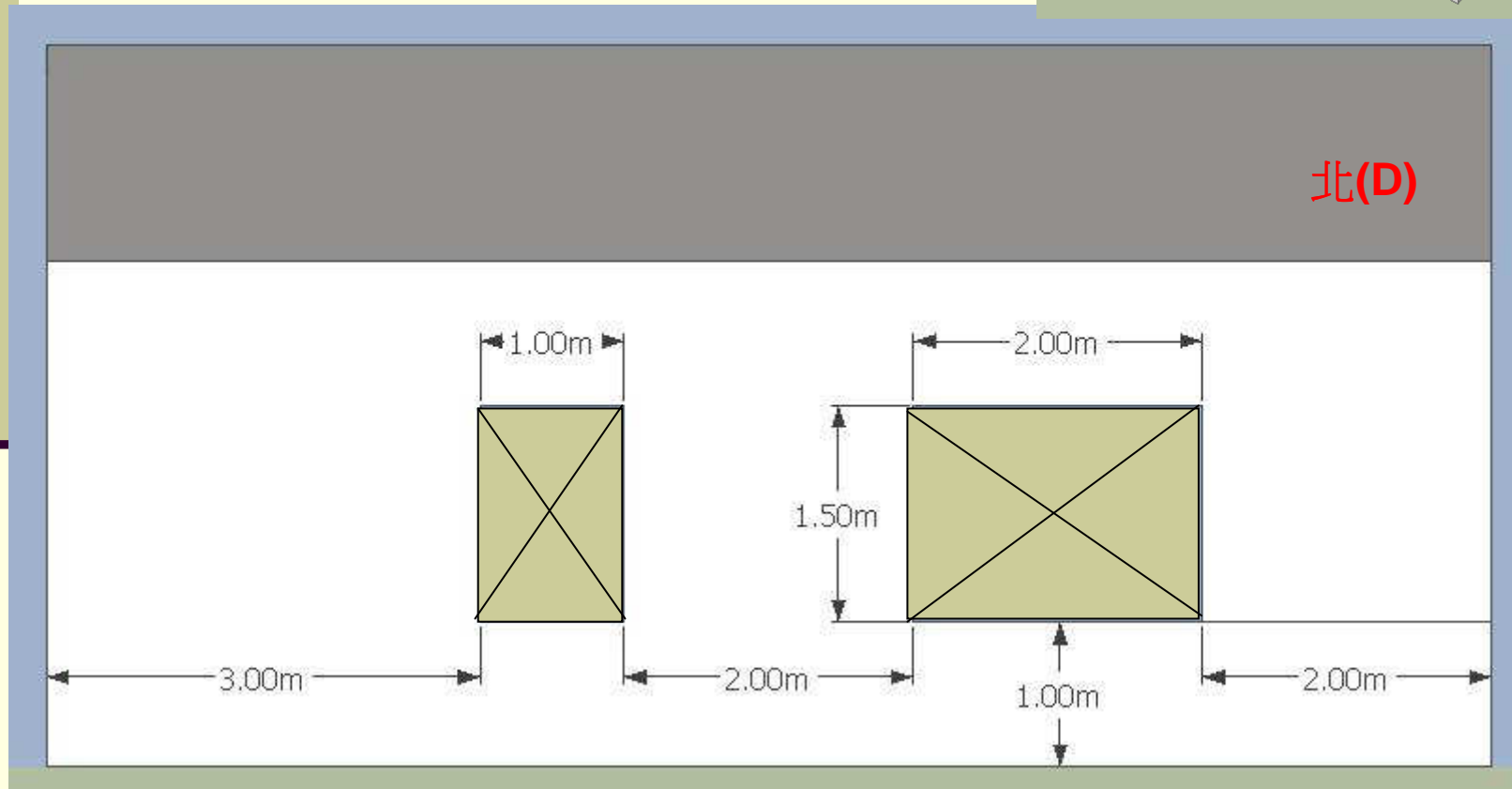
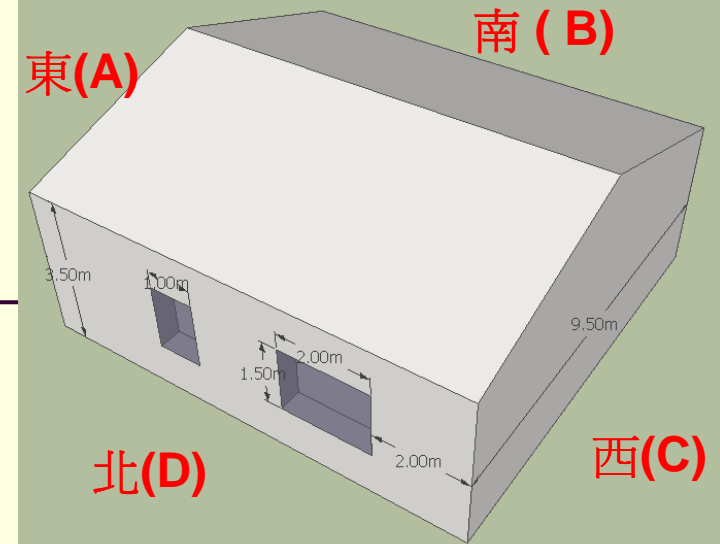

# 屋頂展開形

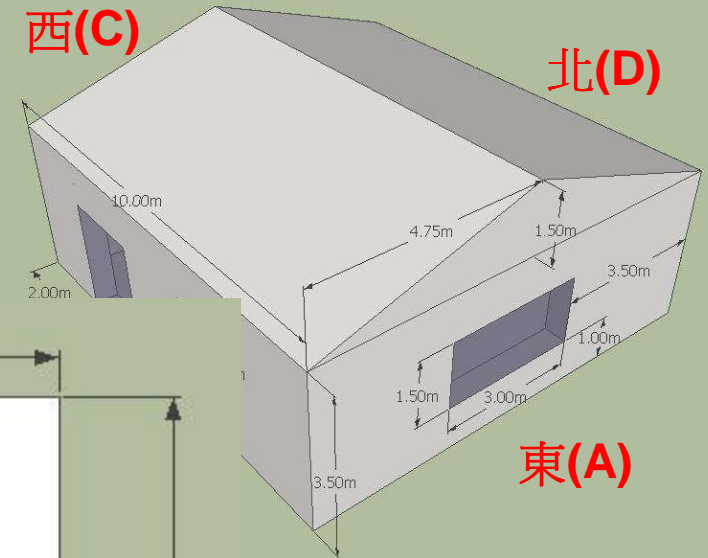



# 模型製作流程



# 切割技巧

---

45度邊：

# 製圓技巧

---

# 注意事項

---

- 相對比例要準確
- 做工要精細
- 質感要強

# 實作技能—裁剪

- 工具：

- 美工刀、切割墊

- 方法：

